



DESK 1

Versatility with style

DESK 1 – every possibility at your fingertips.



Plug connections as standard

The standard power connection features a Wieland plug-in connector in the rear panel and provides both reliable power feed and also flexibility in cable length. The cables can be swapped for longer or shorter power supply cables, for example. We use Wieland's GST18 connector, which is popular all over the world, as standard. This plug connection has a catch mechanism which complies with the relevant standards and can be released again if required. The contacts on the plug connection are safe to touch.

A power output socket provides a means of forwarding power to the next module.

Mounting without damage

DESK 1 can be mounted on the edge of a desk or table quickly and easily using a mounting bracket. A size 4 Allen key is required in order to tighten the inside screw on the bracket. Mounting does not damage the tabletop/desktop. You will find a range of mounting brackets and units on page 39.

DESK 1 plus STEP in combination

Combining DESK 1 with a STEP power strip provides the ideal overall solution for an individual office workstation. DESK 1 provides easy access to power and data connections for various devices (laptop, mobile phone, USB etc.) whilst the STEP power strip under the desk/table top supplies power to fixed devices such as PC, monitor, printer etc. The STEP power strip is screwed in place underneath the top of the desk or table or placed in a duct underneath.

The integrated Wieland connector system allows multiple power strips to be connected in series in compliance with standards.



DESK 1 power strips

 Max. 16A/230V~ See glossary for country-specific information

Power cables and mounting brackets are available separately

Art. no.	Version
Power socket outlets	
Anodised aluminium profile; power input: GST18 / power output: GST18	
902.0048	· 3 socket outlets with earthing contact, child-proof, black, set at 35°, length 270 mm
Power socket outlets	
Anodised aluminium profile; power input: GST18 / power output: GST18	
902.0049	· 4 socket outlets with earthing contact, child-proof, black, set at 35°, length 313 mm
902.0050	· 3 socket outlets with earthing contact, child-proof, black, set at 35° · 1 switch, 2-pole, illuminated · Length 313 mm



DESK 1 power strips

 Max. 16A/230V~ See glossary for country-specific information

with spaces for custom modules

tion

Power cables, custom modules and mounting brackets are available separately

Art. no.	Version
1 x custom module + power socket outlets	
Anodised aluminium profile; power input: GST18 / power output: GST18	
902.000	· 3 socket outlets with earthing contact, child-proof, black, set at 35°, length 322.5 mm
902.017	· 3 socket outlet with earthing contact, child-proof, black, set at 35° · 1 switch, 2-pole, illuminated, length 365 mm
902.004	· 3 French / UTE socket outlets, child-proof, black, set at 35°, length 322.5 mm
902.008	· 3 Swiss / CH socket outlets, black, set at 0°, length 258 mm
2 x custom modules + power socket outlets	
Anodised aluminium profile; power input: GST18 / power output: GST18	
902.001	· 3 socket outlets with earthing contact, child-proof, black, set at 35°, length 365 mm
902.011	· 2 socket outlets with earthing contact, child-proof, black, set at 35°, length 322.5 mm
902.018	· 3 socket outlets with earthing contact, child-proof, black, set at 35°, length 407.5 mm · 1 switch, 2-pole, illuminated
902.005	· 3 French / UTE socket outlets, child-proof, black, set at 35°, length 365 mm
902.009	· 3 Swiss / CH socket outlets, black, set at 0°, length 300.5 mm
902.039*	· 3 UK 3.15A individually fused, child-proof, set at 90°, length 309 mm
902.024	· 2 UK 3.15A individually fused, child-proof, black, set at 45°, length 346.3 mm
3 x custom modules + power socket outlets	
Anodised aluminium profile; power input: GST18 / power output: GST18	
902.002	· 3 socket outlets with earthing contact, child-proof, black, set at 35°, length 407.5 mm
902.019	· 3 socket outlets with earthing contact, child-proof, black, set at 35° · 1 switch, 2-pole, illuminated, length 450 mm
902.006	· 3 French / UTE socket outlets, child-proof, black, set at 35°, length 407.5 mm
902.010	· 3 Swiss / CH socket outlet, black, set at 0°, length 257.5 mm



You can find suitable Wieland cables on page 127

* No storage type

DESK 1 power strips



Max. 16A/230V~ See glossary for country-specific information

with spaces for custom modules

Power cables, custom modules and mounting brackets are available separately

Art. no. | Version

CUSTOM		4 x custom modules + power socket outlets	
Anodised aluminium profile; power input: GST18 / power output: GST18			
	902.003	· 3 socket outlets with earthing contact, child-proof, black, set at 35°, length 450 mm	
	902.007	· 3 French / UTE socket outlets, child-proof, black, set at 35°, length 450 mm	
CUSTOM		2 x custom modules + power socket outlets	
Anodised aluminium profile; power input: 2 x GST18 (black and red)			
	902.012	· 1 socket outlet with earthing contact, child-proof, black, set at 35° · 2 socket outlets with earthing contact, child-proof, red, set at 35°, length 385 mm	
CUSTOM		1 x custom module + power socket outlets + illuminated switch	
Anodised aluminium profile; power input: GST18 / power output: GST18			
	902.017	· 3 socket outlets with earthing contact, child-proof, black, set at 35° · 1 x illuminated switch; length 365 mm	
CUSTOM		2 x custom module + power socket outlets + illuminated switch	
Anodised aluminium profile; power input: GST18 / power output: GST18			
	902.018	· 3 socket outlets with earthing contact, child-proof, black, set at 35° · 1 x illuminated switch; length 407.5 mm	
CUSTOM		3 x custom modules + power socket outlets + illuminated switch	
Anodised aluminium profile; power input: GST18 / power output: GST18			
	902.019	· 3 socket outlets with earthing contact, child-proof, black, set at 35° · 1 x illuminated switch; length 450 mm	

Art. no. | Version

USB CHARGER		CUSTOM		1 x USB double charger (5.2V/2.15A), 1 x custom module + power socket outlets	
Anodised aluminium profile; power input: GST18 / power output: GST18					
	902.0182	· 2 socket outlets with earthing contact, child-proof, black, set at 35°, length 281.3 mm			
	902.0185	· 2 French / UTE socket outlets, child-proof, black, set at 35°, length 281.3 mm			
	902.0184	· 2 UK 3.15A individually fused, child-proof, black, set at 45°, length 300.7 mm			
USB CHARGER		CUSTOM		DESK 1 with 1 x USB double charger (5.2V/2.15A), 2 x custom module + power socket outlets	
Anodised aluminium profile; power input: GST18 / power output: GST18					
	902.0183*	· 2 socket outlets with earthing contact, child-proof, black, set at 35°, length 323.8 mm			
	902.0161	· 2 Swiss / CH socket outlet, black, set at 90°			

You can find suitable Wieland cables on page 127

* No storage type



Max. 16A/230V~

See glossary for country-specific information

- Anodised aluminium profile, black socket outlets
- Incl. standard mounting bracket and screws

Art. no. | Version

DESK 1 3 x earthing contact, GST18 Length: approx. 280 mm
 2 x CAT5e

- 339.1004
- 3 socket outlets with earthing contact, child-proof, black, set at 35°
 - 2 x CAT5e RJ45, front: socket/rear: socket
 - Power input: GST18i3 plug, power output: GST18i3 socket
 - Incl. standard mounting bracket and screws



DESK 1 3 x earthing contact, GST18 Length: approx. 325 mm
 2 x CAT5e, 1 x VGA

- 339.1005
- 3 socket outlets with earthing contact, child-proof, black, set at 35°
 - 2 x CAT5e RJ45, front: socket/rear: socket
 - 1 x VGA 15-pole + mini audio jack 3.5 mm
 - Power input: GST18i3 plug, power output: GST18i3 socket
 - Incl. standard mounting bracket and screws



DESK 1 3 x earthing contact, GST18 Length: approx. 325 mm
 2 x CAT5e, 1 x USB

- 339.1006
- 3 socket outlets with earthing contact, child-proof, black, set at 35°
 - 2 x CAT5e RJ45, front: socket/rear: socket
 - 1 x USB A / A socket
 - Power input: GST18i3 plug, power output: GST18i3 socket
 - Incl. standard mounting bracket and screws



DESK 1 3 x earthing contact, GST18 Length: approx. 225 mm

- 339.1002
- 3 socket outlets with earthing contact, child-proof, black, set at 35°
 - Power input: GST18i3 plug, power output: GST18i3 socket
 - Incl. standard mounting bracket and screws



DESK 1 4 x earthing contact Length: approx. 268 mm
 Fixed connection

- 339.1000
- 4 socket outlets with earthing contact, child-proof, black, set at 35°
 - Power input: 3.0 m, H05VV-F 3G 1.50 mm², black, with right-angled earthing contact plug
 - Incl. standard mounting bracket and screws



DESK 1 3 x earthing contact Length: approx. 268 mm
 Fixed connection, 1 x switch

- 339.1001
- 3 socket outlets with earthing contact, child-proof, black, set at 35°
 - 1 x switch 2-pole green illuminated
 - Power input: 3.0 m, H05VV-F 3G 1.50 mm², black, with right-angled earthing contact plug
 - Incl. standard mounting bracket and screws



* No storage type

DESK 1 automatic switchoff device **approx. €70** Saving per year with multiple peripherals, per workstation

Save energy in the office with Bachmann products



The Bachmann automatic switchoff unit allows efficient savings in power consumption by modern-day office equipment during non-working hours without a major outlay on wiring. Switching equipment off completely is no longer left to chance; power saving now begins as soon as the workstation PC is shut down.

The effectiveness of this system exceeds the savings possible with master-and-slave multiple-socket outlets, since no standby current is drawn by the master device and total power consumption during on-working hours is exactly zero. The automatic switchoff device thus saves energy.

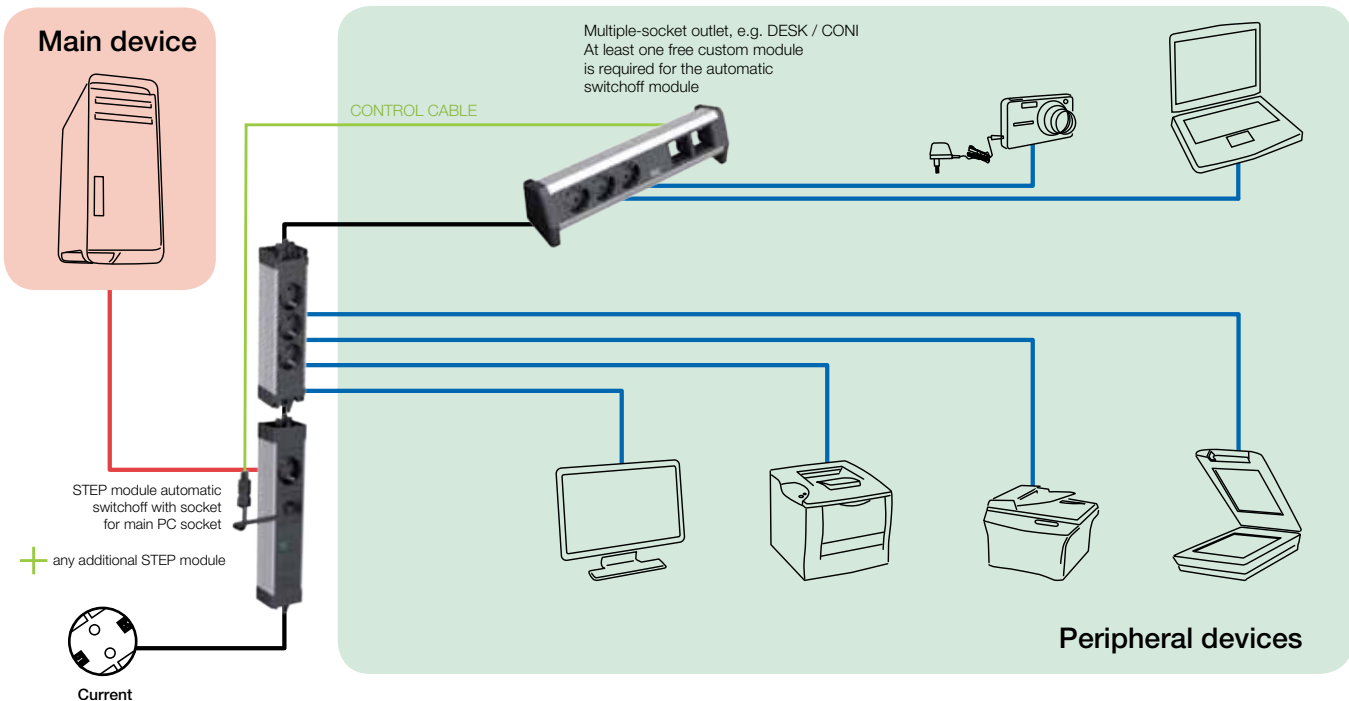

- The advantages at a glance**
- The automatic switchoff will save you up to €70 per workstation per year.
 - An efficient approach to energy pays off. Particularly in relation to your carbon footprint.
 - No electricity – no fire risk.

Automatic switchoff system components



Art. no.	Version	Length: approx. 263 mm
906.005	<ul style="list-style-type: none"> • Anodised aluminium profile • 1 x automatic switchoff device with socket • 1 x button connection with 0.5 m cable and plug-in connector to link to module 917.060 • Power input: GST18i3 plug, power output: GST18i3 socket 	
917.060	<ul style="list-style-type: none"> • 1 x button, black, with 1.0 m cable and 2-way connector • Pressing the button subsequently restores power to the connected equipment. • Use in any power strip with custom modules 	

DESK 1 accessories

Art. no.	Version
DESK 1 slimline brackets for tabletop thicknesses up to 50 mm	
918.001	<ul style="list-style-type: none"> · Stainless steel, thickness 3 mm · Contents: 2 stainless steel mounting brackets + 2 M5 x 45 mm Allen keys
DESK standard brackets for tabletop thicknesses up to 50 mm	
930.120	<ul style="list-style-type: none"> · Anodised aluminium, thickness approx. 9 mm · Contents: - 2 x mounting clamps, anodised aluminium profile - 2 x M5 x 60 mm Allen bolts
DESK 1 long brackets for tabletop thicknesses up to 80 mm	
930.180	<ul style="list-style-type: none"> · Mounting bracket, long, 50-80 mm · Contents: - 2 x mounting clamp, black painted RAL9011 - 2 x M5 x 45 mm Allen bolts - 2 x M5 x 60 mm Allen bolts
Chipboard screw for DESK end caps for tabletop thicknesses over 15 mm	
930.183	<ul style="list-style-type: none"> · 2 x chipboard screws 4 x 90 mm incl. brass threaded sleeve
DESK 1 mounting plate	
930.182	<ul style="list-style-type: none"> · Black plastic · Mounting plates for attachment to DESK end caps · Contents: - 2 x mounting plates - 2 x screws - 2 x TESA POWER STRIP

